

Programme II Stage

FIXED RESILIENT SYSTEM



Programme II Stage offers stabilizing components of steel encased sleepers supported by TriPower™ resilient pads manufactured from recycled rubber material. Along with shock absorbing characteristics, a monolithic sub-floor layer allows numerous floor surface options and loading capabilities associated with stage performances.



Programme II Stage

WALLBASE Maple Floor Surface

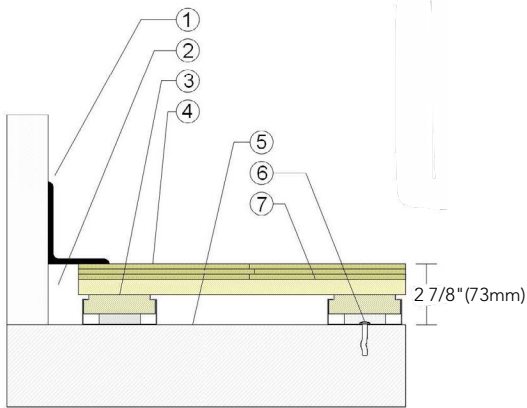

1. 3" x 4" (76mm x 101mm) Vent Cove Base
2. 1-1/2" (38mm) Perimeter Expansion Space
3. Steel Encased Plywood Sleeper with 1/2" (12mm) TriPower Pad
4. 25/32" (20mm) MFMA Maple Flooring
5. Vapor Retarder
6. Steel Concrete Anchor
7. 23/32" (19mm) Plywood Subfloor

THRESHOLD Maple Floor Surface

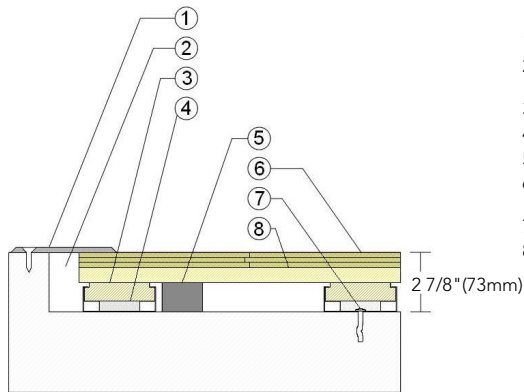

1. 1/4" (6mm) Aluminum Threshold
2. 1-1/2" (38mm) Perimeter Expansion Space
3. Steel Encased Plywood Sleeper
4. 1/2" (12mm) TriPower Pad
5. Solid Blocking at Doorway
6. 25/32" (20mm) MFMA Maple Flooring
7. Steel Concrete Anchor
8. 23/32" (19mm) Plywood Subfloor

HARDBOARD Panel Floor Surface

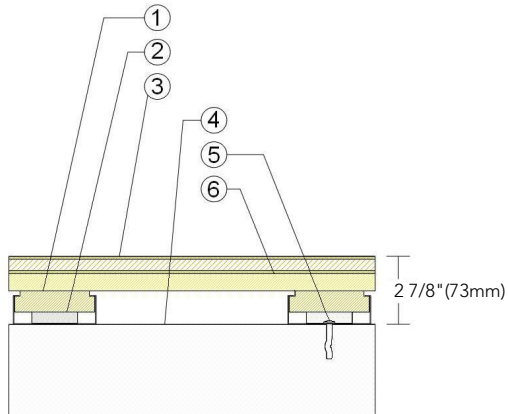

1. Steel Encased Plywood Sleeper
2. 1/2" (12mm) TriPower Pad
3. Hardboard Faced Laminate Panel
4. Vapor Retarder
5. Steel Concrete Anchor
6. 23/32" (19mm) Plywood Subfloor

HARDBOARD Layer Floor Surface

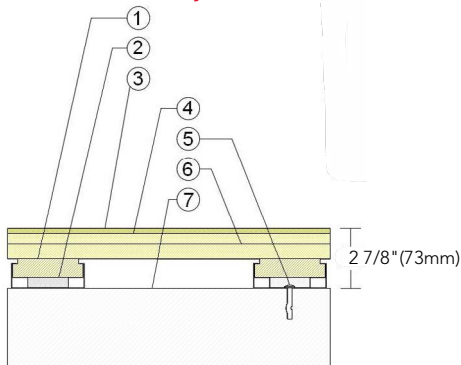

1. Steel Encased Plywood Sleeper
2. 1/2" (12mm) TriPower Pad
3. 1/4" (6mm) Hardboard Surface Layer
4. 15/32" (12mm) Added Plywood Layer
5. Steel Concrete Anchor
6. 23/32" (19mm) Plywood Subfloor
7. Vapor Retarder

Anchorage

Green Status and LEED Contributors

Drill and Pin



- FSC® Certified Maple - MR
- FSC® Certified Subfloor Components - MR
- Environmental Quality - EQ
- Regional Materials - MR

Resilience

1/2" (12mm) TriPower Pad

Slab Depression

- 25/32" (20mm) Flooring - 2-7/8" (73mm)

Optional Programme Systems

Programme I Stage
Programme III Stage

Optional Protection System

PowerVent™ Airflow System

Subfloor Construction

Sleeper Plywood

System Type

Fixed Resilient

Testing Laboratory Partners



It is the policy of Infinity Wood Floors to continuously improve its line of products. Therefore, Infinity Wood Floors reserves the right to change, modify or discontinue systems, specifications and accessories of all products at any time without notice or obligation to purchaser.