

AacerChannel™ VLP

FIXED RESILIENT SYSTEM



The AacerChannel™ VLP performance floor system provides the resiliency and safety of a floating floor and the stability of an anchored system. AacerChannel VLP offers a low profile which can also be considered if satisfying certain heights in retrofit projects.



AacerChannel™ VLP

AacerChannel™ VLP is a fixed resilient sports performance floor system that features a monolithic subfloor with full flex and a full thickness APA engineered underlayment to maximize system performance. The result is a floor with increased stability, shock absorbency, energy return and low vibration.

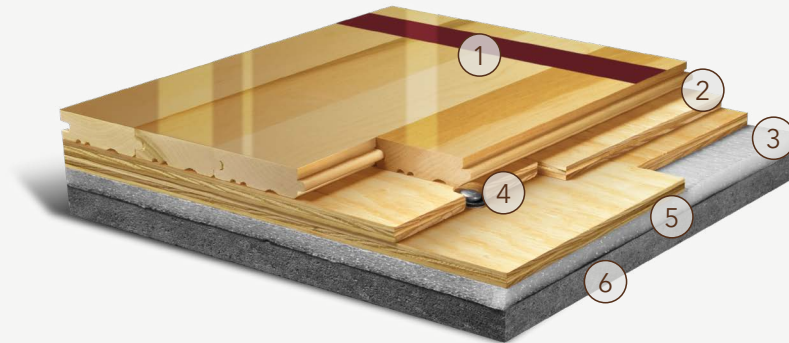

- | | |
|---|-----------------------------|
| 1. Infinity MFMA Maple | 4. Collared Steel Drive Pin |
| 2. Integrated Panels form a Monolithic Subfloor | 5. Vapor Retarder |
| 3. Performance Foam | 6. Concrete |

WALL BASE

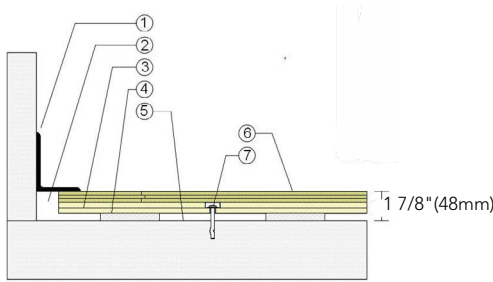

- 3" x 4" (76mm x 101mm) Vent Cove Base
- 1 1/2" (38mm) Min. Expansion Space
- AacerChannel VLP Subfloor Panel
- Resilient Foam Section
- Vapor Retarder
- 25/32" (20mm) MFMA Maple Flooring
- Collared Steel Concrete Anchor

THRESHOLD

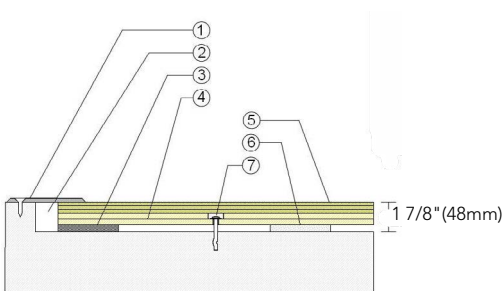

- 1/4" (6mm) Aluminum Threshold
- 1 1/2" (38mm) Min. Expansion Space
- Solid Blocking at Doorway
- AacerChannel VLP Subfloor Panel
- 25/32" (20mm) MFMA Maple Flooring
- Resilient Foam Section
- Collared Steel Concrete Anchor

EQUIPMENT

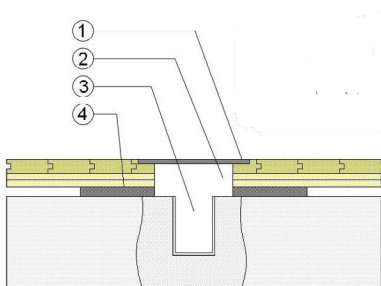

- Floor Plate
- 1 1/2" (38mm) Min. Expansion Space Required at all Insert & Electrical Penetrations
- Concrete Floor Penetration
- Solid Blocking at Insert

Anchorage

Certified

Green Status and LEED Contributors

Resilience

Slab Depression

Optional AacerChannel Systems

Subfloor Construction

System Type

Testing Laboratory Partners

Drill and Pin



- FSC® Certified Maple - MR
- FSC® Certified Subfloor Components - MR
- Environmental Quality - EQ
- Regional Materials - MR

1/2" (12mm) Performance Foam
*Other pad options available.

- 25/32" (20mm) flooring - 1 7/8" (48mm)

AacerChannel VLP HC

Pre-manufactured panels

Fixed Resilient



It is the policy of Infinity Wood Floors to continuously improve its line of products. Therefore, Infinity Wood Floors reserves the right to change, modify or discontinue systems, specifications and accessories of all products at any time without notice or obligation to purchaser.



see us at
Sweets.com

