

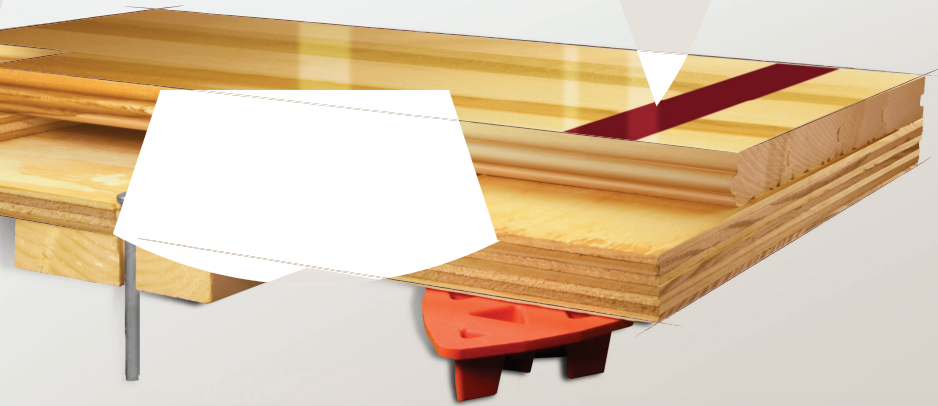

AACER

SPORTS FLOORING



PowerPlay™

A performance sports floor system with shock absorption and resilience at the highest value. This unique combination of high performance, economics and short installation time enhances athletic effectiveness in competition gymnasiums, multipurpose rooms and dance floors.



see us at
Sweets.com



FIXED RESILIENT



PowerPlay™

An anchored performance sports floor system consisting of vapor barrier, pre-engineered cushioned panels, and Acer Maple flooring.

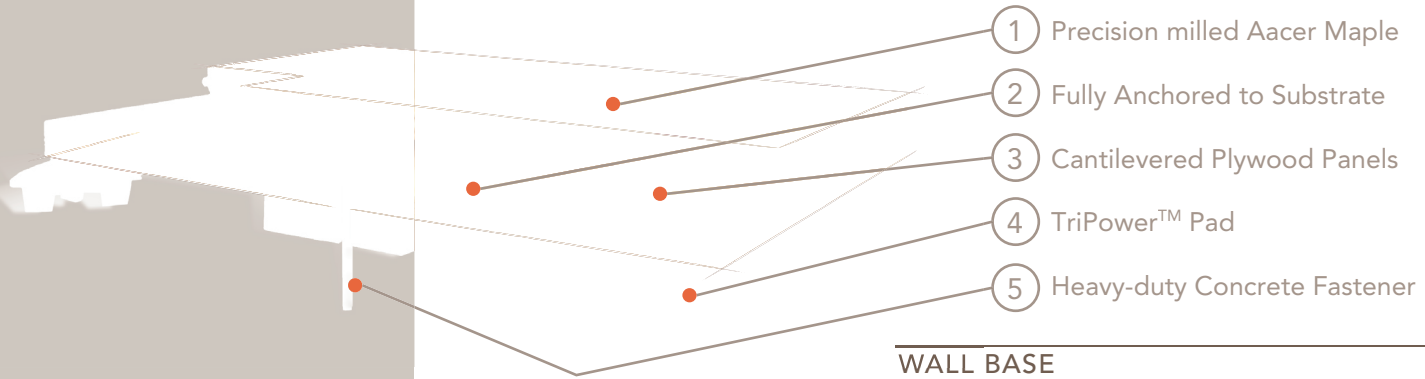

Anchorage	Drill and Pin / Shoot
Certified	
Green Status LEED Contributors	<p>FSC® Certified Maple - MRC7 FSC® Certified SubFloor Components - MRC7 EQ - 4.2 Regional Materials - MRC5.1 & 5.2</p>
Optional Versions	PowerPlay LP, VLP, II, *W, DIN
Resilience	TriPower™, AcerFlex, AcerCush, EcoDIN
Slab Depression	<p>3/8" (10mm) AcerCush Pad PowerPlay VLP 25/32" (20mm) flooring - 1 7/8" (48mm) 33/32" (26mm) flooring - 2 1/8" (54mm)</p> <p>7/16" (11mm) EcoDIN PowerPlay LP, 1/2" (12mm) TriPower™ Pad 25/32" (20mm) flooring - 2 1/8" (54mm) 33/32" (26mm) flooring - 2 3/8" (60mm)</p> <p>3/4" (19mm) TriPower™ Pad PowerPlay DIN 25/32" (20mm) flooring - 2 3/8" (60mm) 33/32" (26mm) flooring - 2 5/8" (67mm)</p>
Subfloor Construction	Pre-manufactured panels
System Type	Fixed Resilient
Testing Laboratory	
U.S. Patent#	*Pending
Warranty	Lifetime available

WALL BASE

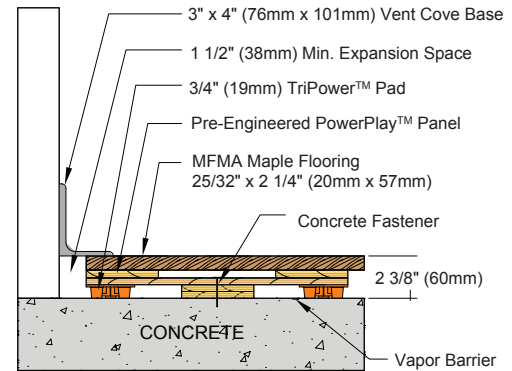

THRESHOLD

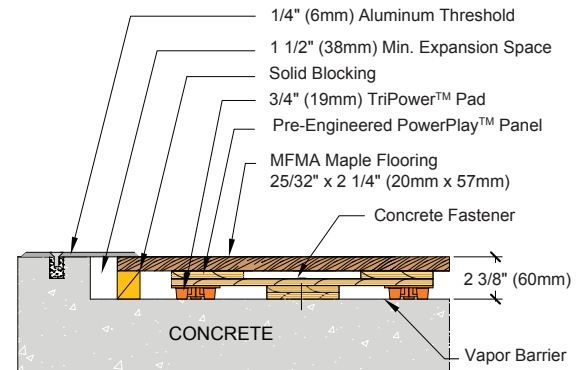

EQUIPMENT

