

AacerChannel™ VLP

FIXED RESILIENT SYSTEMS

The AacerChannel™ VLP performance sports floor system provides the resiliency and safety of a floating floor and the stability of an anchored system. The floor's 100% factory assembled panels ensure uniform performance and fast installation making it ideal for facility retrofit projects and facilities requiring lower profile systems.



AcerChannel™ VLP

AcerChannel™ VLP is a fixed resilient sports performance floor system that features a monolithic subfloor with full flex and a full thickness APA engineered underlayment to maximize system performance. The result is a floor with increased stability, shock absorbency, energy return and low vibration.

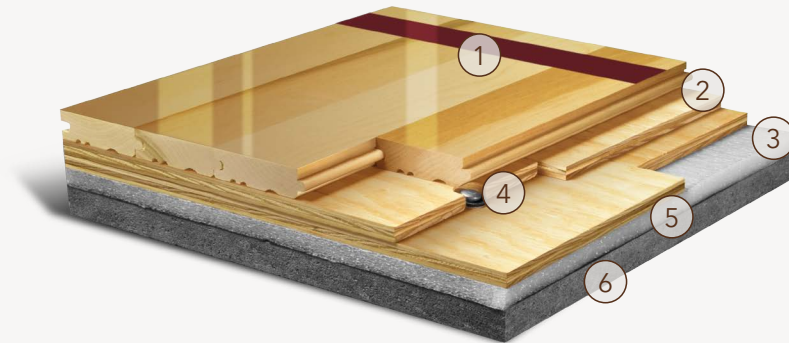

1. Precision-milled Acer Maple
2. Integrated Panels form a Monolithic Subfloor
3. Performance Foam
4. Collared Steel Drive Pin
5. 6 mil Polyethylene Vapor Barrier
6. Concrete

WALL BASE

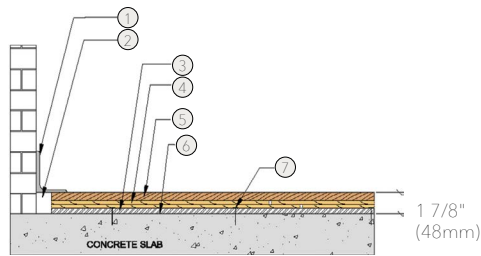

1. 3" x 4" (76mm x 101mm) Vent Cove Base
2. 1 1/2" (38mm) Min. Expansion Space
3. 1/2" (12mm) Performance Foam
4. Pre-Engineered AcerChannel™ VLP Panel
5. MFMA Maple Flooring 25/32" x 2 1/4" (20mm x 57mm)
6. Vapor Barrier
7. Concrete Fastener

THRESHOLD

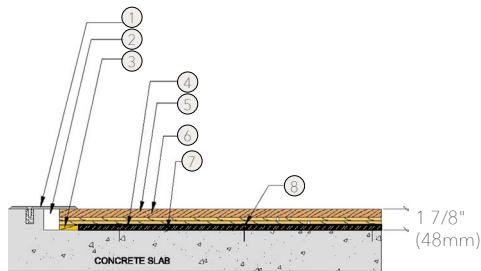

1. 1/4" (6mm) Aluminum Threshold
2. 1 1/2" (38mm) Min. Expansion Space
3. Solid Blocking at Doorways and High Load Areas
4. 1/2" (12mm) Performance Foam
5. Pre-Engineered AcerChannel™ VLP Panel
6. MFMA Maple Flooring 25/32" x 2 1/4" (20mm x 57mm)
7. Vapor Barrier
8. Concrete Fastener

EQUIPMENT

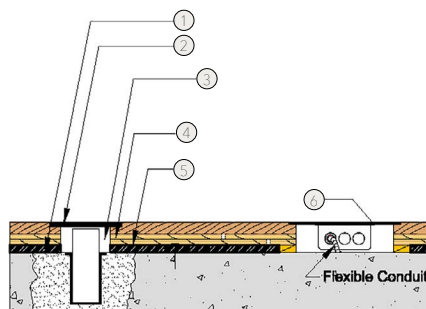

1. Vapor Barrier
2. Floor Plate
3. 1 1/2" (38mm) Min. Expansion Space Required at all Insert & Electrical Penetrations
4. Pre-Engineered AcerChannel™ VLP Panel
5. 1/2" (12mm) Performance Foam
6. Flush Electrical Box or Scorer's Box

Anchorage

Certified

Green Status and LEED Contributors

Resilience

Optional Version

Slab Depression

Subfloor Construction

System Type

Testing Laboratory

U.S. Patent

Warranty

Drill and Pin



- FSC® Certified Maple - MRC7
- FSC® Certified Subfloor Components - MRC7
- EQ - 4.2
- Regional Materials - MRC5.1 & 5.2

Performance Foam

Channeled Foam, 12mm TriPower™ Pad, EcoDIN

- 1/2" (12mm) Performance Foam, 1/2" (12mm) TriPower™ Pads
- 25/32" (20mm) flooring – 1 7/8" (48mm)
- 33/32" (26mm) flooring – 2 1/8" (54mm)

Pre-manufactured panels

Fixed Resilient / Floating



#5,647,183

Lifetime available

It is the policy of Acer Flooring to continuously improve its line of products. Therefore, Acer Flooring reserves the right to change, modify or discontinue systems, specifications and accessories of all products at any time without notice or obligation to purchaser.



see us at
Sweets.com

