

RetroCoustic

FLOATING SYSTEMS

RetroCoustic is a variable profile and versatile impact energy absorbing system consisting of cradles and wood sleepers overlaid with plywood in varying thicknesses.



RetroCoustic

The ability to be shimmed makes this system ideal for retrofit commercial projects and sports applications where uneven sub-surfaces are evident.

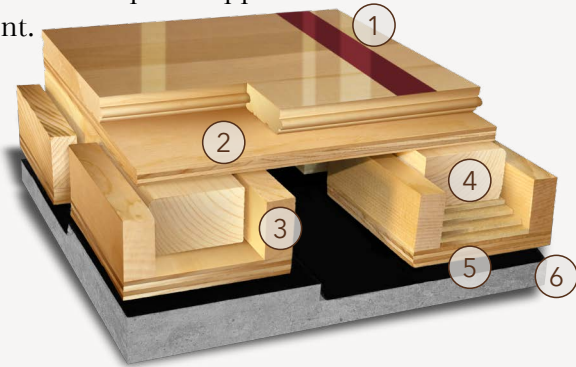

- | | |
|-------------------------------------|---|
| 1. Precision-milled Acer Maple | 4. Nominal 2" x 3" Sleeper or Plywood Sleeper |
| 2. APA Rated Plywood Subfloor Layer | 5. EcoDIN Pad |
| 3. RetroCoustic Cradle | 6. Vapor Barrier |

WALL BASE

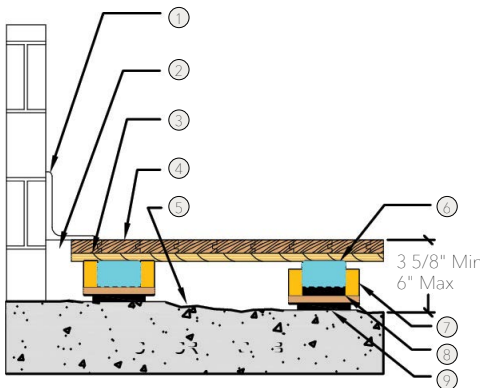

- 3" x 4" (76mm x 101mm) Vent Cove Base
- 1 1/2" (38mm) Min. Expansion Space
- 15/32" CDX Plywood
- MFMA Maple Flooring 25/32" x 2 1/4" (20mm x 57mm)
- Vapor Barrier
- Nominal 2" x 3" Sleeper
- RetroCoustic Cradle
- Shims, as required
- 7/16" EcoDIN Pad

THRESHOLD

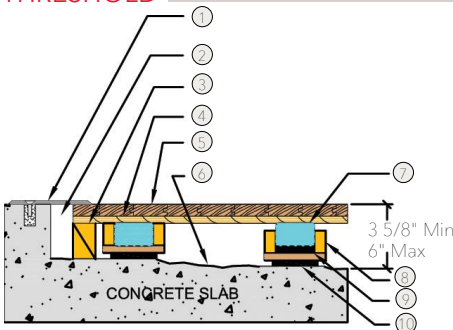

- 1/4" (6mm) Aluminum Threshold
- 1 1/2" (38mm) Min. Expansion Space
- Solid Blocking
- 15/32" CDX Plywood
- MFMA Maple Flooring 25/32" x 2 1/4" (20mm x 57mm)
- Vapor Barrier
- Nominal 2" x 3" Sleeper
- RetroCoustic Cradle
- Shims, as required
- 7/16" EcoDIN Pad

EQUIPMENT

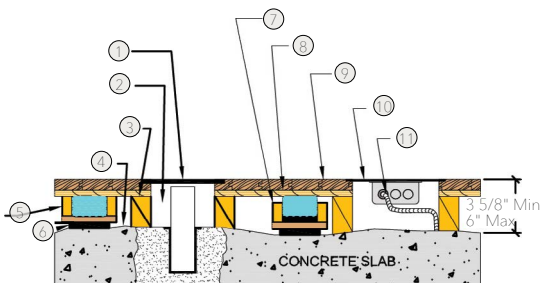

- Floor Plate
- 1 1/2" (38mm) Min. Exp. Space Req'd at all Insert & Electrical Penetrations
- Solid Blocking at Floor Insert Penetrations
- Vapor Barrier
- RetroCoustic Cradle
- 7/16" EcoDIN Pad
- RetroCoustic Cradle
- 15/32" CDX Plywood
- MFMA Maple Flooring 25/32" x 2 1/4" (20mm x 57mm)
- Flush Electrical Box or Scorer's Box
- Flexible Conduit

Green Status and LEED Contributors



- FSC® Certified Maple - MRc7
- FSC® Certified Subfloor Components - MRc7
- EQ - 4.2
- Regional Materials - MRc5.1 & 5.2

Resilience

7/16" EcoDIN Pads
*Other options available. Contact your Regional Sales Manager.

Slab Depression

- 15/32" (12mm) Plywood
- 25/32" (18mm) flooring - 3 5/8" ++
 - 33/32" (26mm) flooring - 3 7/8" ++

- 25/32" (19mm) Plywood
- 25/32" (18mm) flooring - 3 7/8" ++
 - 33/32" (26mm) flooring - 4 1/8" ++

Subfloor Construction

Specialized Sleeper and Plywood

System Type

Floating

Testing Laboratory



Warranty

Lifetime available

Slab Variance

2 1/2" allowable variance

It is the policy of Acer Flooring to continuously improve its line of products. Therefore, Acer Flooring reserves the right to change, modify or discontinue systems, specifications and accessories of all products at any time without notice or obligation to purchaser.



see us at Sweets.com

