

# AacerChannel™ LP

FIXED RESILIENT SYSTEMS

A high performance sports floor system with the resiliency and safety of a floating floor and the stability of an anchored system. This unique combination is ideal for large field houses and combination wood and synthetic facilities.



# AcerChannel™ LP

AcerChannel™ LP enhances performance in gymnasiums, dance floors and multipurpose facilities.



- |   |  |
|---|--|
| 1. Precision-milled Acer Maple                  | 4. 16-gauge Steel Anchored to Concrete |
| 2. Integrated Panels form a Monolithic Subfloor | 5. 6mil Polyethylene Vapor Barrier     |
| 3. 1/2" (12mm) TriPower™ Pad                    | 6. Concrete                            |

## WALL BASE

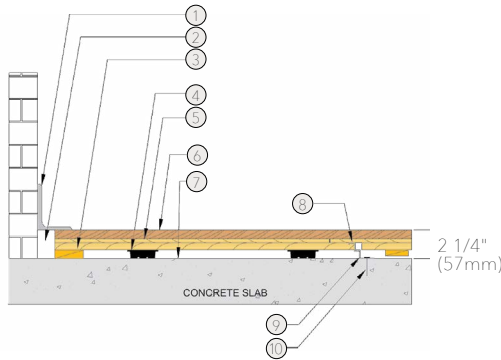

- 3" x 4" (76mm x 101mm) Vent Cove Base
- 1 1/2" (38mm) Min. Expansion Space
- Solid Blocking at Doorways & High Load Areas
- 1/2" (12mm) TriPower™ Pad
- Pre-Engineered AcerChannel™ Panel
- MFMA Maple Flooring 25/32" x 2 1/4" (20mm x 57mm)
- Vapor Barrier
- Receiver Channel
- Anchor Channel
- Concrete Fastener

## THRESHOLD

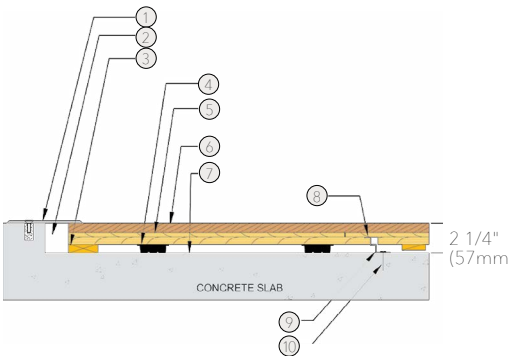

- 1/4" (6mm) Aluminum Threshold
- 1 1/2" (38mm) Min. Expansion Space
- Solid Blocking at Doorways & High Load Areas
- 1/2" (12mm) TriPower™ Pad
- Pre-Engineered AcerChannel™ Panel
- MFMA Maple Flooring 25/32" x 2 1/4" (20mm x 57mm)
- Vapor Barrier
- Receiver Channel
- Anchor Channel
- Concrete Fastener

## EQUIPMENT

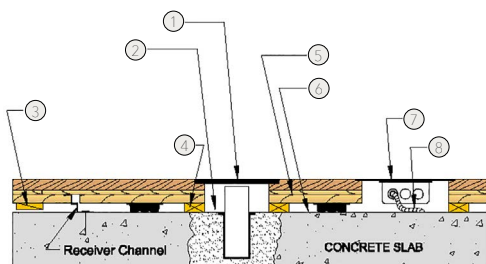

- Floor Plate
- 1 1/2" (38mm) Min. Expansion Space Required at all Insert & Electrical Penetrations
- 1/2" (12mm) Stop Blocking for Rolling Load Protection
- Solid Blocking at Floor Insert Penetrations
- Pre-Engineered AcerChannel™ Panel
- Vapor Barrier
- Flush Electrical Box or Scorer's Box
- Flexible Conduit

Anchorage

Certified

Drill and Pin



Green Status and LEED Contributors



- FSC® Certified Maple - MRC7
- FSC® Certified Subfloor Components - MRC7
- EQ - 4.2
- Regional Materials - MRC5.1 & 5.2

Optional Version

AcerChannel

Resilience

TriPower™ Pads  
\*Other pad options available.  
Contact your Regional Sales Manager.

Slab Depression

AcerChannel LP with 1/2" (12mm) TriPower™ or 7/16" (11mm) EcoDIN Pads

- 25/32" (20mm) flooring – 2 1/4" (57mm)
- 33/32" (26mm) flooring – 2 1/2" (64mm)

Subfloor Construction

Pre-manufactured panels

System Type

Fixed Resilient

Testing Laboratory



U.S. Patent #

#5,647,183

Warranty

Lifetime available

*It is the policy of Acer Flooring to continuously improve its line of products. Therefore, Acer Flooring reserves the right to change, modify or discontinue systems, specifications and accessories of all products at any time without notice or obligation to purchaser.*



see us at  
**Sweets.com**

