

A Shock Absorbing Performance System.

AacerFlex BP

AacerFlex with the Bi-Power® Pad

Special design improves playability and safety of the athlete.



AacerFlex with the Bi-Power® pad is a performance sports floor system which incorporates the latest technology and design in its Bi-Power pads to maximize resiliency, deflection and shock absorption to the athlete. The Bi-Power pad minimizes potential deadspots by increasing pad surface contact area without compromising the load bearing ability of the system.



- 3/4" pad
- Made of Elastomeric TPR rubber
- Special O-ring design ensures uniform response
- 4-point contact pad
- Premium performance pads
- Sport-specific design
- Immediate and intermittent contact creates greater load handling
- Best recuperation of any pad on the market
- Greatest area of contact of any performance pad on the market

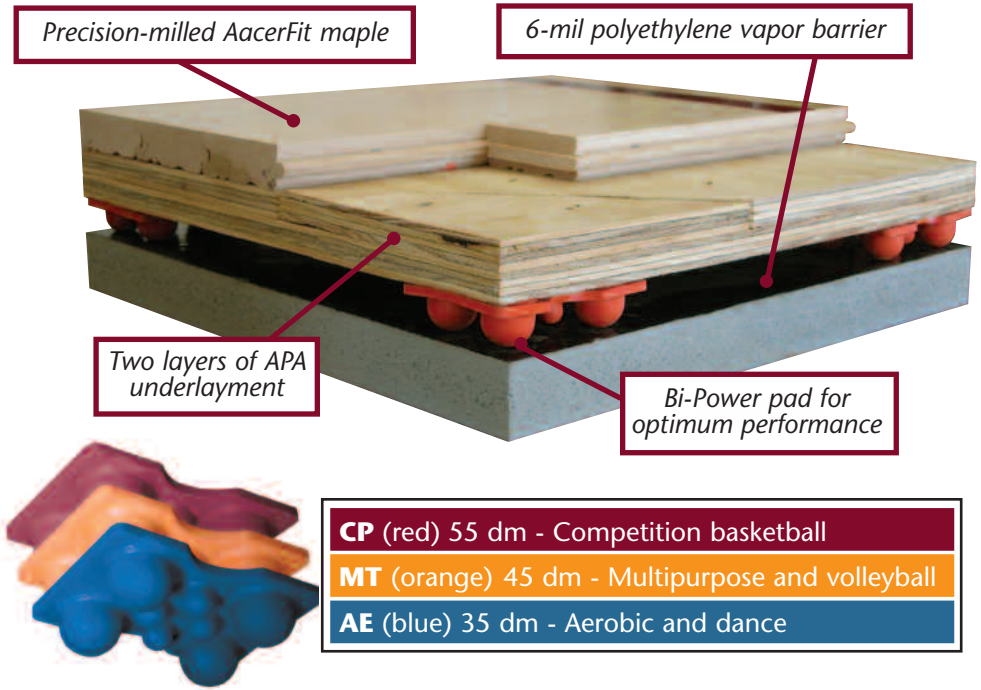

Part I – GENERAL

A. A floating performance sports floor system consisting of vapor barrier, two layers of underlayment, resilient Bi-Power® Pads and Acer maple flooring.

1. The concrete slab depression for 25/32" thick maple flooring with Bi-Power shall be 2-1/2".

B. See general specifications on page 4.

Part II – PRODUCTS

2.1 – Materials

- A. Vapor barrier shall be 6-mil polyethylene.
- B. Resilient Subfloor Pads
Acer Bi-Power® Pad.

Options: Blue, Red or Orange.

C. Subfloor

1. Underlayment – 2 layers of 15/32" x 4' x 8' APA rated underlayment with an exposure rating of 1.
2. Underlayment Attachment
1" coated staples or equivalent

D. Flooring – Acer Maple

25/32" x 2-1/4" 2nd & Better Grade Northern Hard Maple flooring tongued, grooved and end-matched as manufactured by Acer Flooring, LLC. Flooring will be graded, marked and stamped in accordance with the standards established by the Maple Flooring Manufacturers Association (MFMA).

Options:

Sizes – 25/32" x 1-1/2", 2-1/2"; 33/32" x 1-1/2"; and 33/32" x 2-1/4"

Grades – First Grade and Third Grade

Wall Base Detail

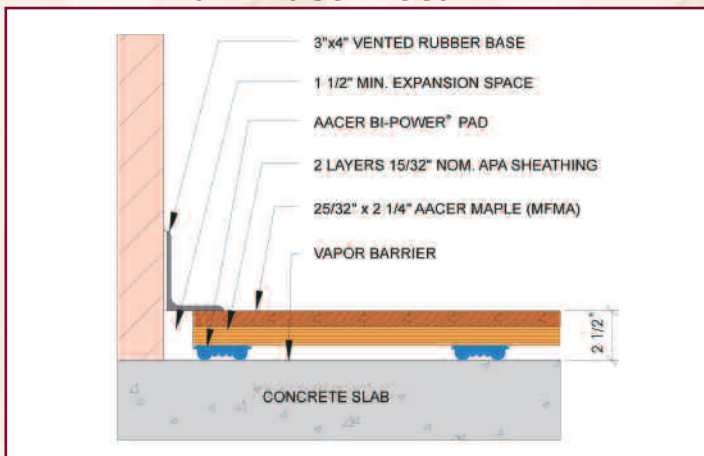

Threshold Detail

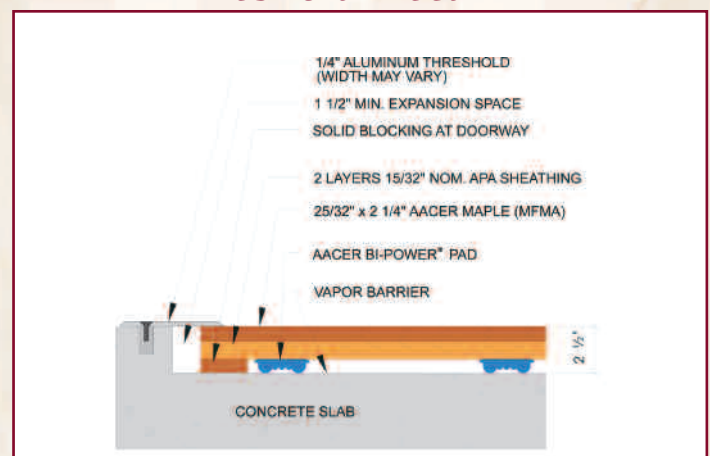

For complete details see Acer shop drawings at www.acerflooring.com

- E. Flooring fasteners shall be 2" barbed cleats.
- F. Wall base shall be 3" x 4" molded vent cove base.

Part III – EXECUTION

3.1 – Pre-Installation Inspection

- A. Floor installer shall verify slab tolerance of concrete and report any corrections to General Contractor and Architect in writing. Room shall be broom cleaned and free of any foreign material.
- B. Floor installer shall document site and working conditions prior to and during installation. This documentation shall become a part of any warranty and may or may not affect fulfillment of any warranty.

3.2 – Installation

- A. Cover entire slab with 6-mil polyethylene, sealing and lapping joints a minimum of 6".
- B. Subfloor
 - 1. Aacer Bi-Power® Pads shall be attached to first underlayment layer 12" O.C. (32 per sheet) and 6" from underlayment edges on all sides. Install first layer of underlayment with pads facing down perpendicular to the orientation of the long dimension of the maple flooring and breaking rows by 4'. Allow 1/4" spacing between sheets.

- 2. The second layer of subfloor material shall be laid diagonally at 45° angles over the first layer with 1/4" spacing on all edges, breaking rows at 4'. Second layer shall be attached using 1" coated staples, or equivalent, at a minimum of 12" O.C.
- 3. Load Requirements – Install solid blocking under bleachers in the stacked position. Install stop blocking under bleachers in the extended position or heavy load areas as required.

Option:
Both layers of underlayment may be laid at 45° angles (criss cross fashion) to finish flooring.

- C. Aacer Maple Flooring
 - 1. Install Aacer maple flooring parallel with the long dimension of room. Flooring shall be power nailed every 10" to 12" O.C. with all end joints properly driven tight.
 - 2. Expansion joints may be required between flooring strips intermittently throughout the floor. Requirements will be determined by site and geographical conditions.
 - 3. Provide a minimum 1-1/2" expansion void at all walls and permanent obstructions.

3.3 – Floor Sanding

- A. Machine sand entire floor with multiple grit papers to a smooth and uniform surface, free from edger marks and drum drops.
- B. Remove all sanding dust and lint from entire surface by vacuum and/or tack.

3.4 – Finishing and Gamelines

- A. Inspect entire floor to be sure surface is ready to accept seal/finish. Floor should be free from dust and debris.
- B. Apply seal and finish per manufacturer's label instructions.
- C. Floor shall be buffed, cleaned and tacked between coats.
- D. Gamelines – apply game lines and logos as indicated by drawings. Paint shall be compatible with finish.

3.5 – Base Installation

Install vent cove base with cove base adhesive and/or mechanical attachment to walls. Use pre-molded outside corners and mitered inside corners.

3.6 – Documentation

Provide job condition documentation to owner with any warranties.

Electrical Detail

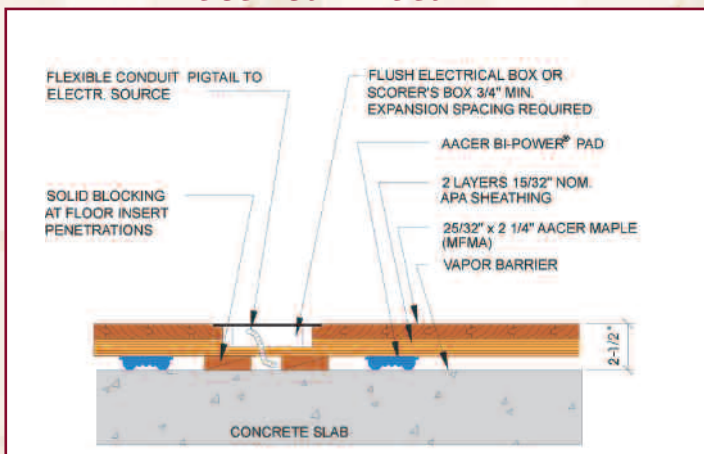

Insert Detail

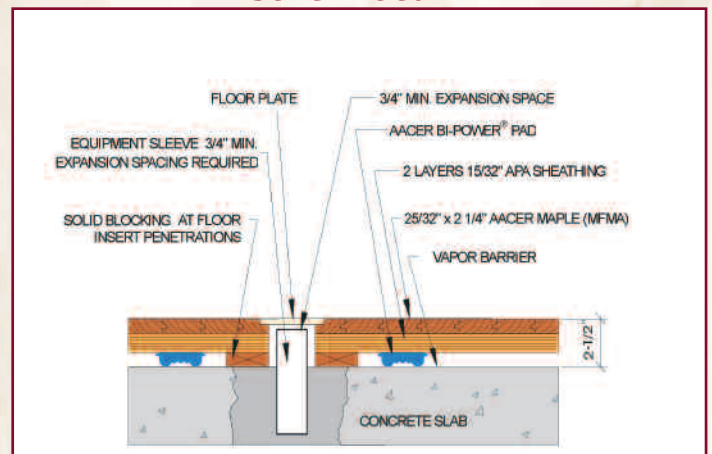

Part I – General Specifications

These specifications provide strict guidelines that must be adhered to for proper installation and performance of the materials supplied by Acer Flooring, LLC.

1.1 – Description

A. Related Work

1. Concrete Substrate – Section 03300
 - a. The concrete contractor shall furnish and install the concrete substrate depressing the slab in relation to surrounding areas in order to accommodate the floor system. The slab shall be smooth troweled and finished to a tolerance of 1/8" in a 10' radius. High spots shall be ground and low spots shall be filled with an approved leveling compound by the concrete contractors to meet the full approval of the floor installer.
2. Waterproofing Membrane – Section 07100
 - a. Concrete subfloor at or below grade shall be adequately vapor-proofed and/or waterproofed beneath the slab and at the perimeter of below grade walls by the general contractor using a suitable type membrane.
3. Thresholds – Section 08700
 - a. Thresholds or transitional entryways shall be designed and installed to adequately accommodate the expansion and contraction of the wood floor system. Thresholds and transitionways shall be installed by the flooring contractor.
4. Game Standard Inserts – Section 11500

1.2 – References

- A. MFMA Maple Flooring Manufacturers Association

1.3 – Quality Assurance

- A. Manufacturer – Manufacturer of athletic flooring shall be Acer Flooring, LLC
- B. Flooring Contractor/Installer – The installation of the floor system described in these specifications shall be completed by a firm familiar with the requirements of the system specified and fully experienced in procedures required for installing athletic flooring manufactured by Acer Flooring, LLC.

revised 1/08



1.4 – Submittals

- A. Submit Acer Flooring, LLC specification sheets and shop drawings as required.
- B. Samples – submit the required number of samples of the specified System as requested by the owner/architect.
- C. Maintenance Guidelines – upon completion of floor send the Acer Floor Maintenance Guide to the owner. This guide will explain the Proper HVAC and building maintenance requirements as well as floor cleaning and servicing guidelines to assure proper floor performance and longevity.

1.5 – Working Conditions

- A. The wood flooring and its components specified herein shall not be delivered or installed until all wet trades and overhead work is completed. This includes all masonry, painting, plaster, tile, marble and terrazzo, as well as all overhead mechanical trades. The building shall be fully enclosed and weather tight and all permanent windows and doorways shall be installed. Permanent heating and air conditioning shall be installed and working in accordance with building occupation requirements.
- B. The concrete substrate shall be determined fully cured by industry standards. It shall be free of all foreign materials and broom clean when turned over to the floor installer. Permanent HVAC units for the building shall have been operating a minimum of one week prior to floor installation start up.
- C. During and after installation, building HVAC and lighting systems shall maintain a temperature and humidity range compatible with the expected high and low moisture content range of the flooring. The floor installer, based on the building's HVAC control and geographical situation, shall determine this range.
- D. Flooring must be stored on site in a dry, well-ventilated area while acclimating to site conditions. Moisture content of wood shall be consistent with the ambient conditions of the building as it will be maintained when occupied.

1.6 – Warranty and Disclaimer

- A. Acer Flooring, LLC, Peshtigo, WI, hereby warrants the materials, it has supplied to be free from manufacturing defects for a period of one year. **THIS WARRANTY IS IN LIEU OF AND EXCLUDES ALL OTHER WARRANTIES EXPRESSED OR IMPLIED INCLUDING ANY IMPLIED WARRANTIES OF MERCHANTABILITY OR FITNESS FOR A PARTICULAR PURPOSE.**
- B. This warranty is limited to the materials manufactured by and supplied by Acer Flooring, LLC. THIS WARRANTY EXCLUDES ANY CONSEQUENTIAL OR INCIDENTAL DAMAGES and, in the event of breach, Acer Flooring, LLC's sole liability and your exclusive remedies will be limited to repair or replacement of material and components supplied by Acer Flooring, LLC and proven to be defective by the manufacturing process.
- C. During the warranty period, the floor shall not be recoated without the approval of the flooring contractor.
- D. The jobsite documentation forms by the flooring contractor shall become a part of the warranty and both the owner and flooring contractor shall retain record of said forms as a permanent reference for any abrogation.
- E. Flooring contractor warrants the installation of the floor systems to be free from defects in materials and workmanship for a period of one year.
- F. It is the policy of Acer Flooring to continuously improve its line of products. Therefore, Acer Flooring reserves the right to change, modify or discontinue systems, specifications and accessories of all products at any time without notice or obligation to purchaser.



P.O. Box 151 • 970 Ogden Rd. • Peshtigo, WI 54157
Toll-Free 877-582-1181 • Fax: 715-582-1182 • www.acerflooring.com
Bi-Power® is a registered trademark of Prestige Enterprise International.



Performance
Tested

